

ORDINANCE NO. 2025-41

AN ORDINANCE TO APPROVE THE ANNEXATION OF TERRITORY WITHIN THE
CITY LIMITS OF THE CITY OF LOXLEY, ALABAMA
(The Fort Storage, LLC)

WHEREAS, on the 25th day of June 2025, Geoff Lane (As Member) being the owner of all the real property hereinafter described, did file with the City Clerk a petition asking that the said tract or parcel of land be annexed to and become a part of the City of Loxley; and

WHEREAS, said petition did contain the signatures of all the owners of the described territory and a map of said property showing its relationship to the corporate limits of the City of Loxley; and

WHEREAS, the governing body did determine that it is in the public interest that said property be annexed to the City of Loxley and it did further determine that all legal requirements for annexing said real property have been met pursuant to Sections 11-42-20 through 11-42-24, Code of Alabama, 1975;

NOW, THEREFORE, BE IT ORDAINED BY THE CITY COUNCIL OF LOXLEY, ALABAMA, AS FOLLOWS:

Section 1. The Council of the City of Loxley, Alabama finds and declares as the legislative body of the City that it is in the best interests of the citizens of the City, and the citizens of the affected area, to bring the territory described in Section 2 of this ordinance into the City of Loxley.

Section 2. The boundary lines of the City of Loxley, Alabama, be, and the same are hereby altered or rearranged so as to include all of the territory heretofore encompassed by the corporate limits of the City of Loxley, Alabama, and in addition thereto the following described territory, to-wit:

Parcel No. 05-33-03-07-0-000-005.002
PIN: 118757

BEGINNING AT A CAPPED REBAR (26014) AT THE SOUTHEAST CORNER OF SECTION 7, TOWNSHIP 4 SOUTH, RANGE 3 EAST, BALDWIN COUNTY, ALABAMA AND RUN THENCE NORTH 89 DEGREES 40 MINUTES 31 SECONDS WEST, A DISTANCE OF 1558.74 FEET TO A CAPPED REBAR (26014) ON THE EAST MARGIN OF U.S HIGHWAY 31 (80 FOOT RIGHT-OF-WAY); THENCE RUN NORTH 06 DEGREES 06 MINUTES 05 SECONDS EAST, ALONG SAID EAST MARGIN, A DISTANCE OF 888.67 FEET TO A CAPPED REBAR (0036) AT THE SOUTHWEST CORNER OF CHURCHILL DOWNS, PHASE ONE (AMENDED), AS SHOWN BY MAP OR PLAT THEREOF RECORDED AT SLIDE 2329-F, PROBATE RECORDS, BALDWIN COUNTY, ALABAMA; THENCE DEPARTING SAID EAST MARGIN, RUN SOUTH 89 DEGREES 40 MINUTES 20 SECONDS EAST, ALONG THE SOUTH LINE OF SAID CHURCHILL DOWNS, A DISTANCE OF 1462.74 FEET TO A CAPPED REBAR (ILLEGIBLE) AT THE SOUTHEAST CORNER OF SAID CHURCHILL DOWNS; THENCE RUN SOUTH 00 DEGREES 05 MINUTES 59 SECONDS EAST, A DISTANCE OF 884.11 FEET TO THE POINT OF BEGINNING. TRACT CONTAINS 30.66 ACRES, MORE OR LESS, AND LIES IN THE SOUTHEAST QUARTER OF SECTION 7,

Section 3. This ordinance shall be published as provided by law, and a certified copy of same, together with a certified copy of the petition of the property owners, shall be filed with the Probate Judge of Baldwin County, Alabama

Section 4. The territory described in this ordinance shall become a part of the corporate limits of Loxley, Alabama, upon publication of this ordinance as set forth in Section 3 above.

ADOPTED THIS THE 25TH DAY OF AUGUST, 2025.

Richard L. Teal
Mayor

Attest:

Melissa Lawrence
City Clerk/Treasurer

CERTIFICATION

I, Melissa Lawrence, City Clerk of the City of Loxley, Alabama hereby certify the above to be true and correct copy of an ordinance adopted by the City Council of the City of Loxley at its meeting held on the 25th day of August, 2025, as same appears in the minutes or record of said meeting.

I further certify that copies of the ordinance above were published by posting copies thereof at the Loxley Post Office, Loxley City Hall, Loxley Public Library, and Loxley Public Works beginning August 27, 2025, and took effect five days thereafter.

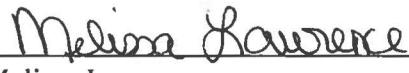

Melissa Lawrence
City Clerk/Treasurer

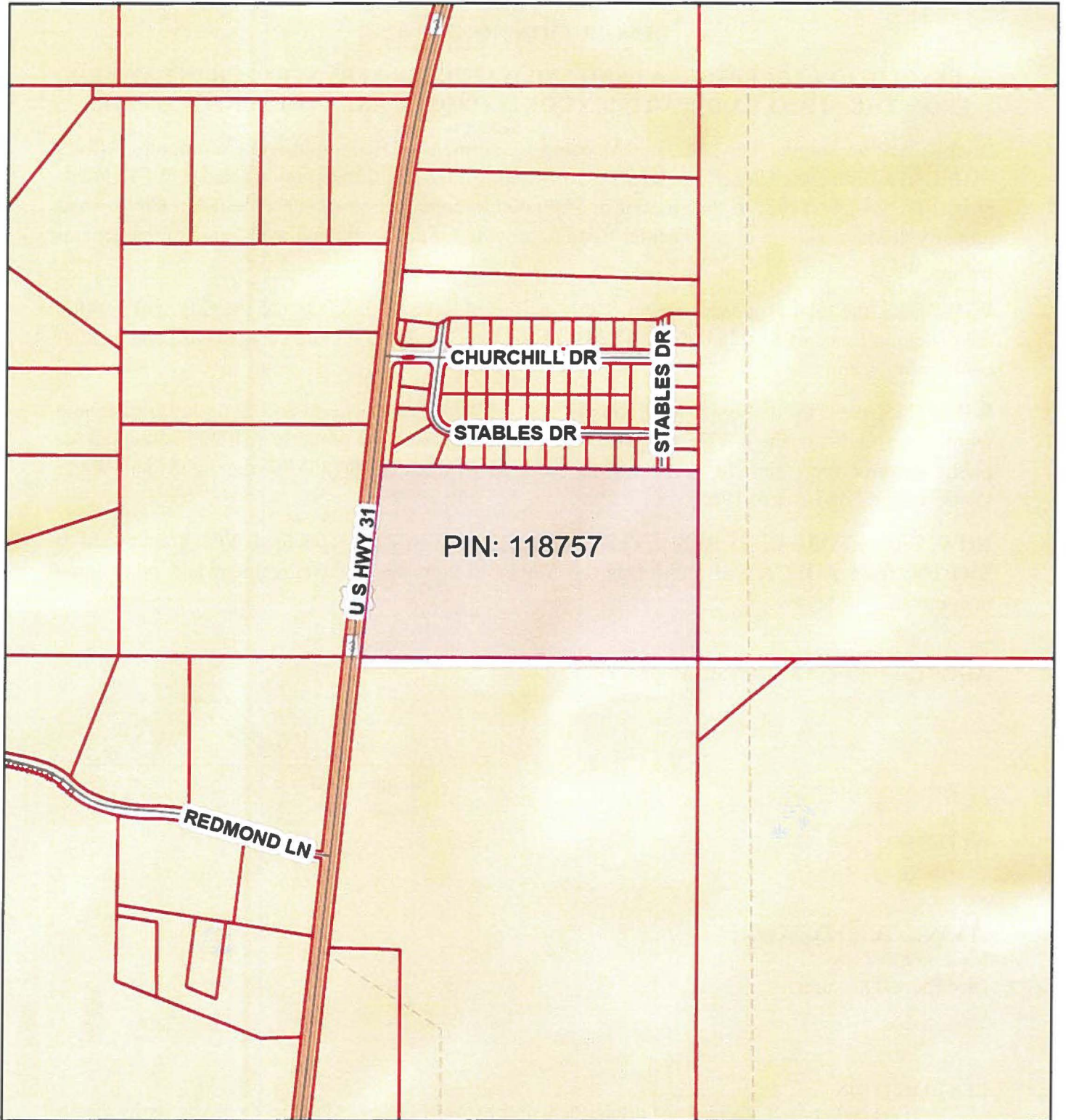
The Fort Storage, LLC



September 12, 2025

1:9,028

-  Override 1
-  County Boundary
-  Lot Lines
-  Centerlines
-  Parcels

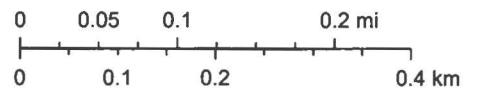

Esri, HERE, Garmin, INCREMENT P, NGA, USGS

Copyright 2025